



McLane, Graf,
Raulerson & Middleton
Professional Association

900 Elm Street | P.O. Box 326 | Manchester, NH 03105-0326
Tel: 603.625.6464 | Fax: 603.625.5650 | www.mclane.com

OFFICES IN:
MANCHESTER
CONCORD
PORTSMOUTH
WOBURN, MA

CATHRYN E. VAUGHN
Direct Dial: (603) 628-1180
Email: cathryn.vaughn@mclane.com
Licensed in NH

November 1, 2011

Thomas S. Burack, Chairman
Site Evaluation Committee
NH Department of Environmental Services
29 Hazen Drive
Concord, NH 03302

Re: SEC Docket No. 2011-01 – Berlin Station

Dear Chairman Burack:

I enclose for filing in the above captioned matter two landscaping plans that were prepared by John Wacker & Associates, Inc. and deemed acceptable by the City of Berlin as documented in the May 5, 2011 approval signed by Pamela E. Laflamme, City Planner, City of Berlin, previously filed with the Site Evaluation Committee on September 26, 2011. A hard copy of the plans and a disc containing electronic copies are enclosed for your convenience. If you have any questions, please do not hesitate to contact me.

Very truly yours,

A handwritten signature in black ink, appearing to read "Cathryn E. Vaughn". The signature is fluid and cursive, with a long horizontal stroke extending to the right.

Cathryn E. Vaughn

Enclosure

cc: All counsel of record (via email)

PLANT LIST - STREETSCAPE

#	Code	Common Name	Size	Botanical Name
48	BF	BALSAM FIR	30@10' 18@12'	Abies Balsamea
106	WP	WHITE PINE	65@10' 41@12'	Pinus Strobus
8	GM	GREEN MTN MAPLE	3"-3 1/2"	Acer Saccharum 'Green Mountain'
32	TC	GREENSPIRE LINDEN	3"-3 1/2"	Tilia Cordata 'Greenspire'
28	PA	PATMORE ASH	3"-3 1/2"	Fraxinus Pennsylv. 'Patmore'
21	SM	STEEPLE MAPLE	3"-3 1/2"	Acer Saccharum 'Steeple'
20	RB	RIVER BIRCH	12' Clumps 3 Stem Min.	Betula Nigra 'Heritage'
37	FM	FALL FIESTA MAPLE	3"-3 1/2"	Acer Saccharum 'Fall Fiesta'
20	TL	TREE LILAC	3"-3 1/2"	Syringa Reticulata 'Ivory Silk'
15	AM	AUTUMN BLAZE MAPLE	3"-3 1/2"	Acer Saccharum 'Autumn Blaze'
10	HC	HORSECHESTNUT	3"-3 1/2"	Aesculus Hippocast. 'Fl. McHair'
16	PB	PAPER BIRCH	12' clumps 3 Stem min.	Betula Papyrifera

MILL SITE - BERLIN - PLANTING NOTES:

- Exact location for all plants will be approved on the site by the Landscape Architect after Landscape Contractor staking.
- Landscape Contractor shall submit 1 cubic yard sample of agricultural loam of fertile, friable soil suitable for all loam for planting and provide for loam testing of 3 samples, to an approved testing agency to show admixtures to be supplied in each tree pit for proper plant growth.
- All plants on the plant lists are specified by common names and botanical names taken from the book of Standardized Plant Names.
- Discrepancies between plan and plant lists will be resolved by Landscape Contractor adherence to all plan drawing requirements as noted.
- Planting installation and tree staking for all trees shall be performed as shown by the details. Stakes shall remain for one year and be removed by Landscape Contractor after Owner approval.
- Maintenance of plants shall begin at the time of planting with deep watering during planting and then each plant shall be flooded again within the first 24 hours and watered thereafter every 3 days for the first 30 days. Thereafter, the Contractor shall water plants weekly to insure proper soil moisture until the fall season and deciduous leaves turn color or drop and are otherwise going dormant. It is important to continue to provide watering for evergreen trees up until the ground freezes to provide enough moisture through the winter.
- All plants shall be guaranteed for one full year. After inspection by the Owner and Landscape Architect, all plants not growing in true form and character shall be replaced of like size and species as the original planting plans, and be guaranteed for one more year.
- All plants shall be supplied to the project site in accordance with the American Standard for Nursery Stock as to root ball methods, sizes, and conditions in all respects, including proper covering of stock during transport.
- There are some existing trees along Hutchins Road mostly of scrub growth plus a few evergreens by the scale. It is assumed that during the earthwork process along the road, the moving of the fence, and the layout and site preparation of the ATV Trail that all trees will be removed.

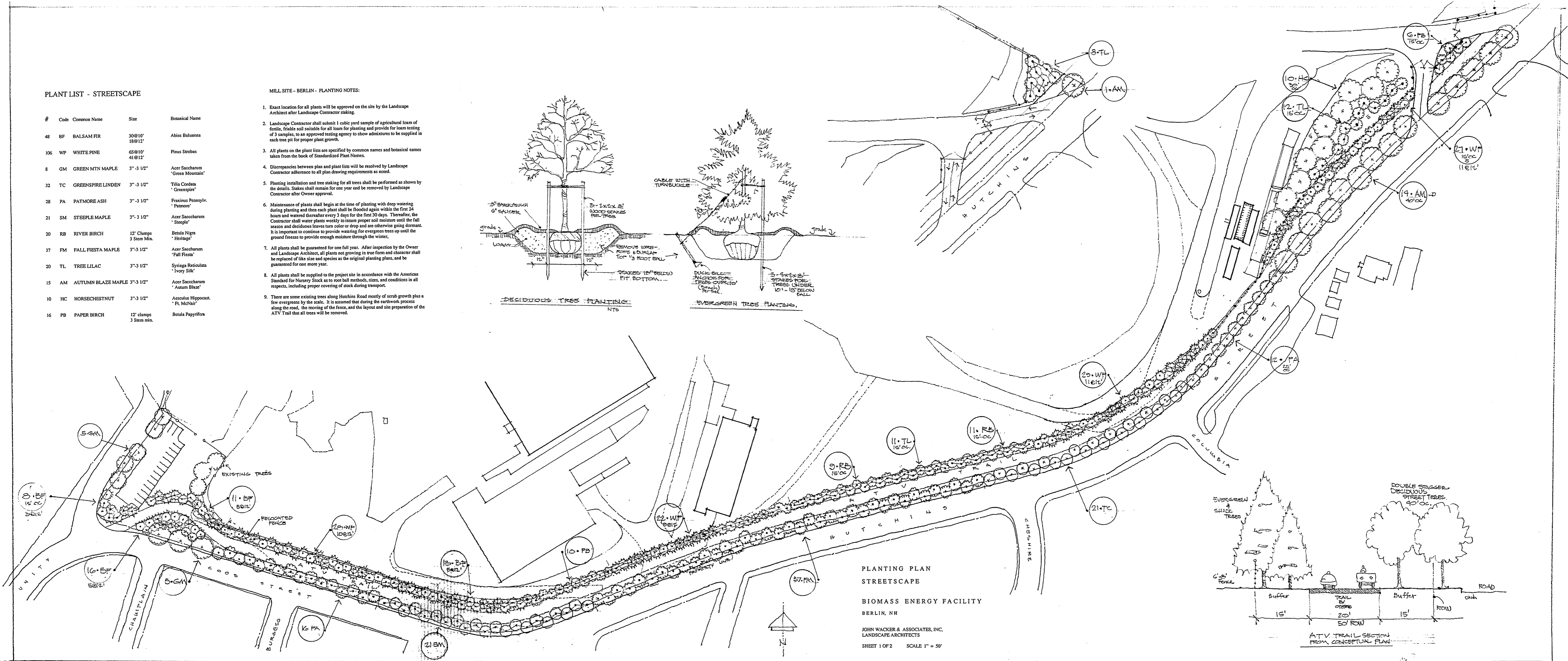
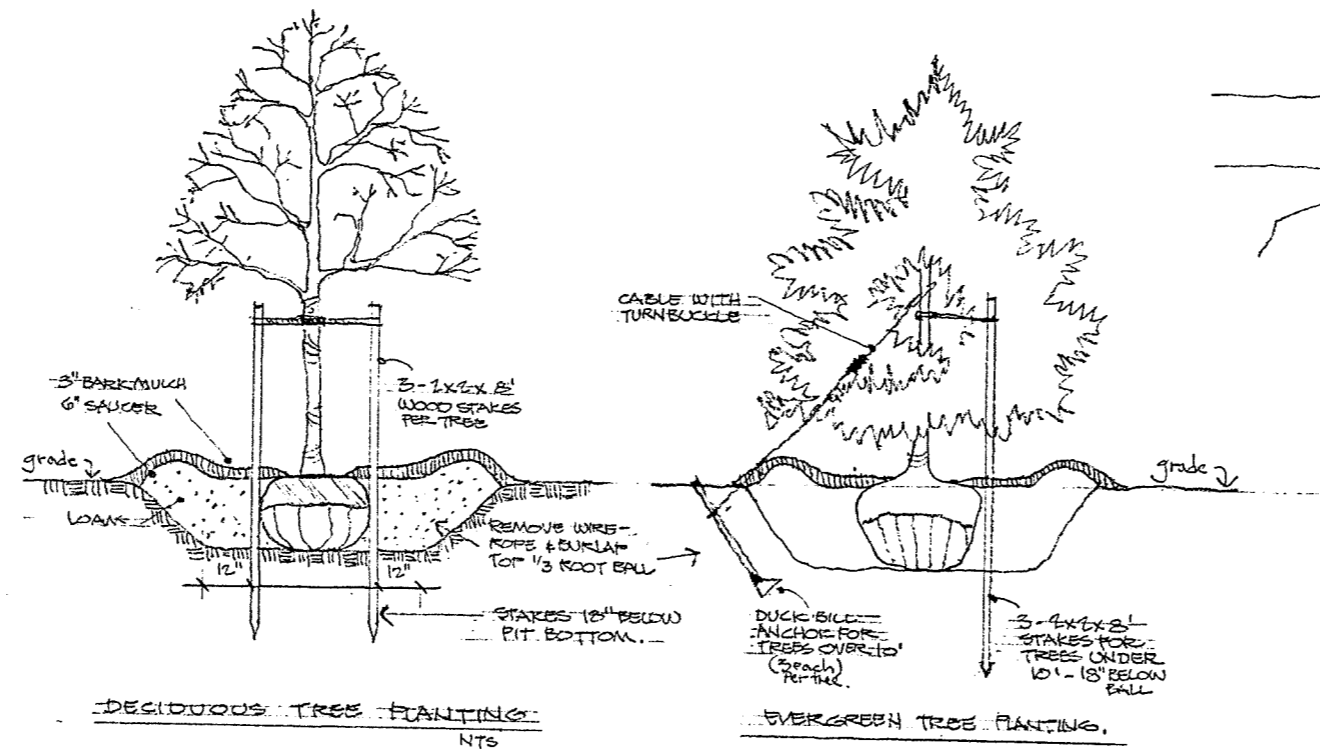

PLANTING PLAN
STREETSCAPE
BIOMASS ENERGY FACILITY
BERLIN, NH
JOHN WACKER & ASSOCIATES, INC.
LANDSCAPE ARCHITECTS
SHEET 1 OF 2 SCALE 1" = 50'

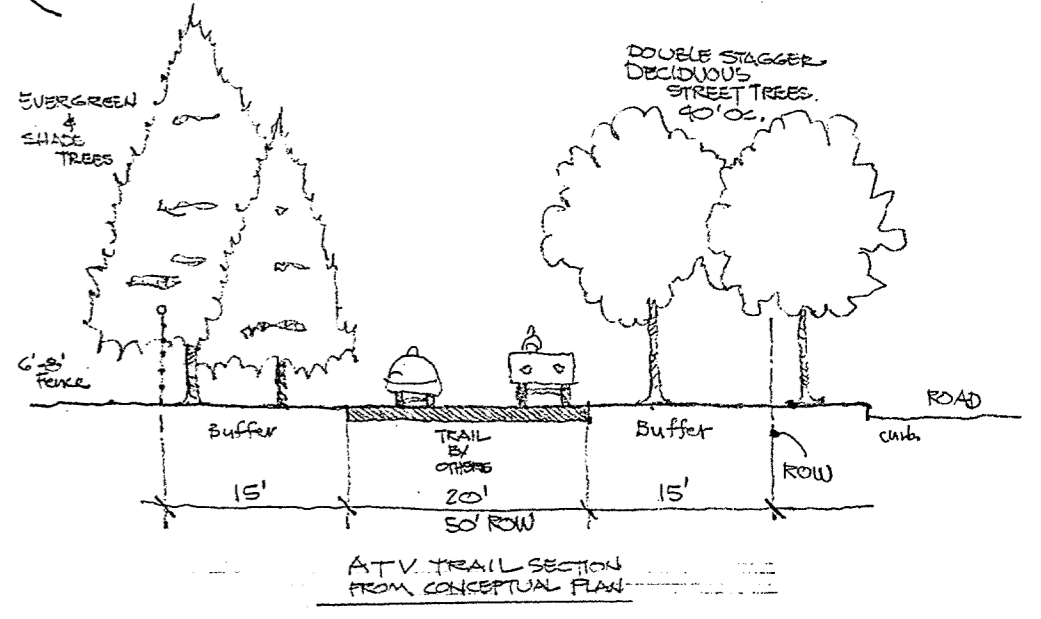

PLANT LIST - STREETSCAPE

#	Code	Common Name	Size	Botanical Name
48	BF	BALSAM FIR	30@10' 18@12'	Abies Balsamea
106	WP	WHITE PINE	65@10' 41@12'	Pinus Strobus
8	GM	GREEN MTN MAPLE	3"-3 1/2"	Acer Saccharum 'Green Mountain'
32	TC	GREENSPIRE LINDEN	3"-3 1/2"	Tilia Cordata 'Greenspire'
28	PA	PATMORE ASH	3"-3 1/2"	Fraxinus Pennsylv. 'Patmore'
21	SM	STEEPLE MAPLE	3"-3 1/2"	Acer Saccharum 'Steeple'
20	RB	RIVER BIRCH	12' Clumps 3 Stem Min.	Betula Nigra 'Heritage'
37	FM	FALL FIESTA MAPLE	3"-3 1/2"	Acer Saccharum 'Fall Fiesta'
20	TL	TREE LILAC	3"-3 1/2"	Syringa Reticulata 'Ivory Silk'
15	AM	AUTUMN BLAZE MAPLE	3"-3 1/2"	Acer Saccharum 'Autumn Blaze'
10	HC	HORSECHESTNUT	3"-3 1/2"	Aesculus Hippocast. 'Fl. McHair'
16	PB	PAPER BIRCH	12' clumps 3 Stem min.	Betula Papyrifera

MILL SITE - BERLIN - PLANTING NOTES:

- Exact location for all plants will be approved on the site by the Landscape Architect after Landscape Contractor staking.
- Landscape Contractor shall submit 1 cubic yard sample of agricultural loam of fertile, friable soil suitable for all loam for planting and provide for loam testing of 3 samples, to an approved testing agency to show admixtures to be supplied in each tree pit for proper plant growth.
- All plants on the plant lists are specified by common names and botanical names taken from the book of Standardized Plant Names.
- Discrepancies between plan and plant lists will be resolved by Landscape Contractor adherence to all plan drawing requirements as noted.
- Planting installation and tree staking for all trees shall be performed as shown by the details. Stakes shall remain for one year and be removed by Landscape Contractor after Owner approval.
- Maintenance of plants shall begin at the time of planting with deep watering during planting and then each plant shall be flooded again within the first 24 hours and watered thereafter every 3 days for the first 30 days. Thereafter, the Contractor shall water plants weekly to insure proper soil moisture until the fall season and deciduous leaves turn color or drop and are otherwise going dormant. It is important to continue to provide watering for evergreen trees up until the ground freezes to provide enough moisture through the winter.
- All plants shall be guaranteed for one full year. After inspection by the Owner and Landscape Architect, all plants not growing in true form and character shall be replaced of like size and species as the original planting plans, and be guaranteed for one more year.
- All plants shall be supplied to the project site in accordance with the American Standard for Nursery Stock as to root ball methods, sizes, and conditions in all respects, including proper covering of stock during transport.
- There are some existing trees along Hutchins Road mostly of scrub growth plus a few evergreens by the scale. It is assumed that during the earthwork process along the road, the moving of the fence, and the layout and site preparation of the ATV Trail that all trees will be removed.

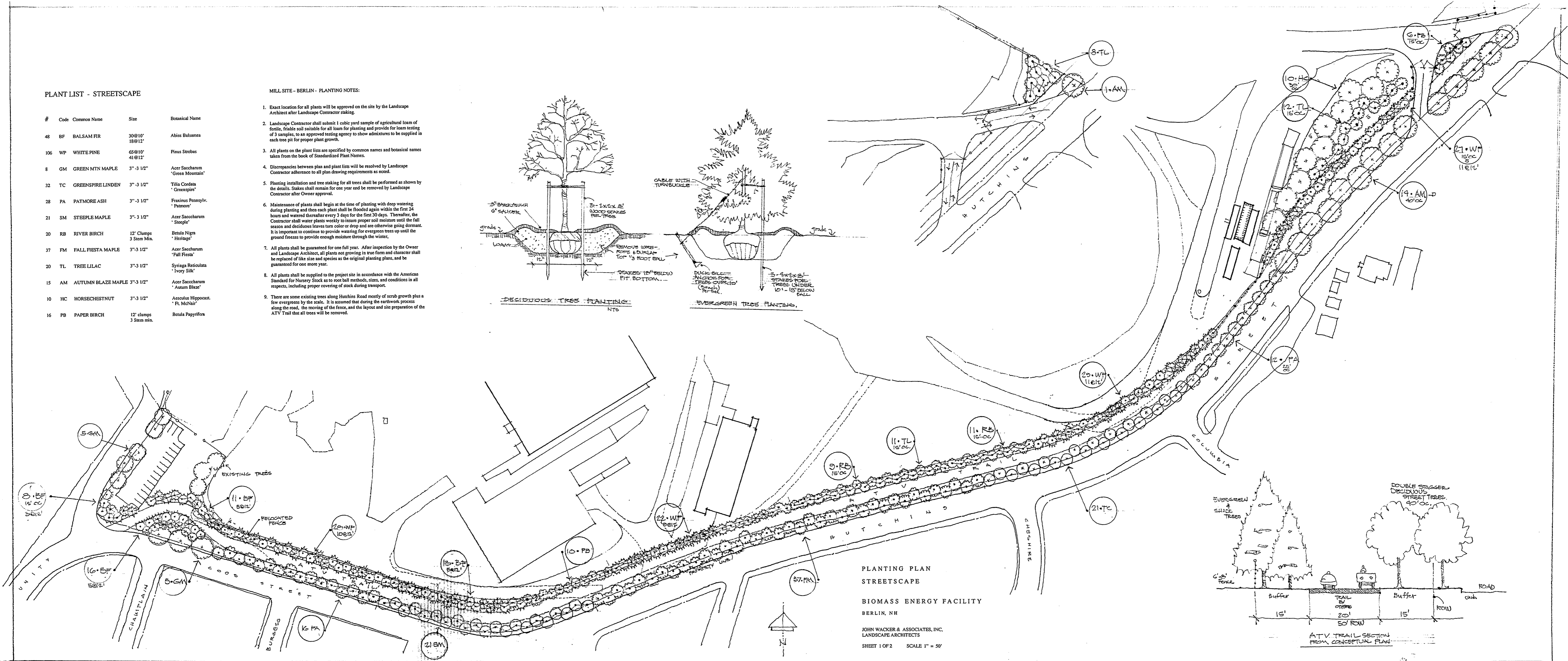
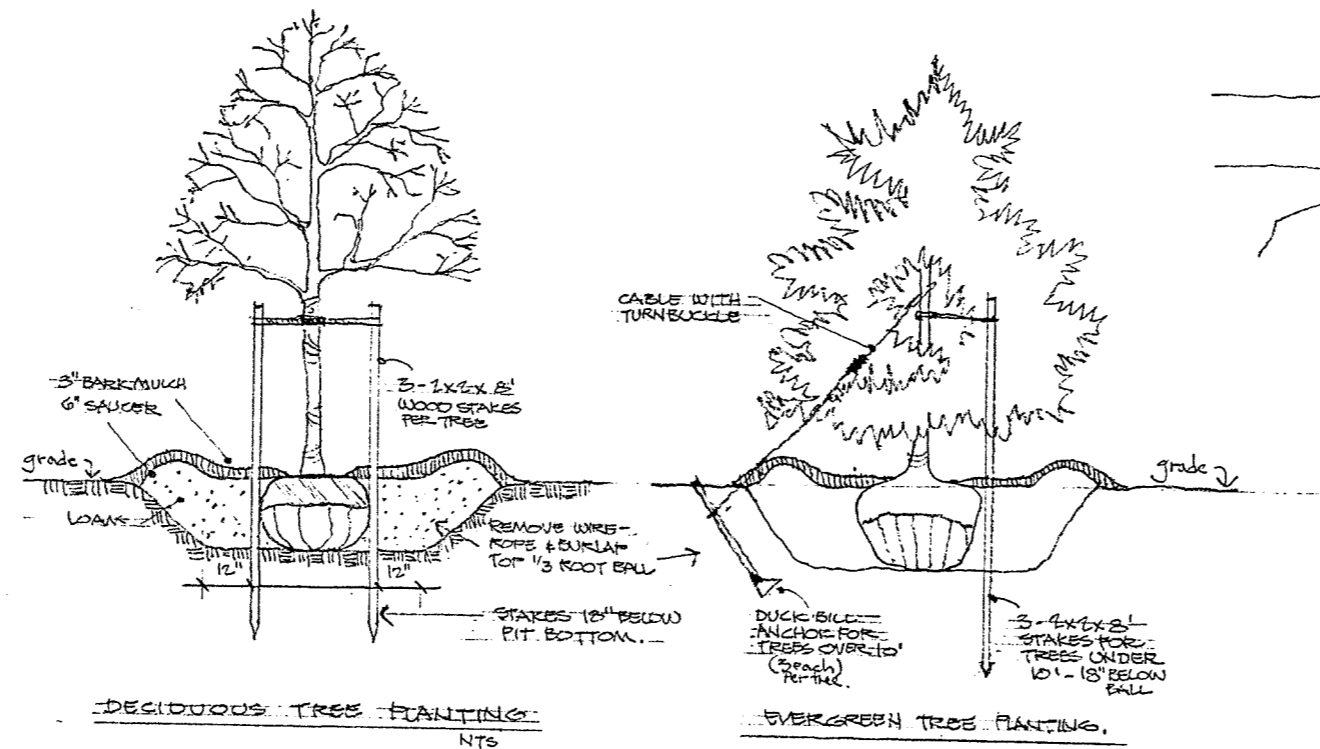

PLANTING PLAN
STREETSCAPE
BIOMASS ENERGY FACILITY
BERLIN, NH
JOHN WACKER & ASSOCIATES, INC.
LANDSCAPE ARCHITECTS
SHEET 1 OF 2 SCALE 1" = 50'

